

Pos.	Materiali impiegati Materials - Matériaux utilisés
1	Metallo - Metal - Métallique Zn Al4 Cu1 UNI EN 1774
14	Acciaio - Steel - Acier
2-4-5-6-11 19-24-27-28	Tecnopolimero Technopolymer - Techno-polymère
7	PTFE
10	Acciaio classe C UNI 3823 - Steel - Acier
14	Rame - Copper - Cuivre
14	Vetro - Glass - Verre
22-29	Alluminio - Aluminium - Aluminium AL-Cu 6 B; Pb UNI EN 573/3
3-8-9-14-15 17-18-26-28	Ottone - Brass - Laiton CuZn39Pb3 UNI EN 12164
20	Acciaio inox Stainless steel - Acier inoxydable AISI 302
11-12-13-16 18-21-23-30	Gomma NBR - Rubber - Caoutchouc
25	Bronzo sinterizzato Sintered bronze - bronze frite

Dimensioni Dimensions - Dimensions		A	B	B1	C	D	E	F	G
	1/2" BSP	71,5	63	103	303	88	215	Ø 55	35

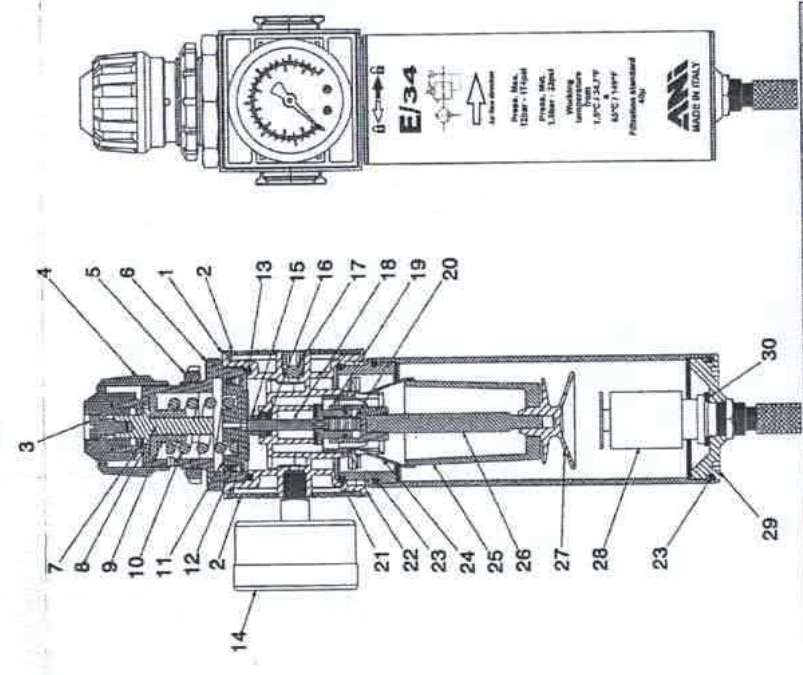

Esempio di assemblaggio con staffe di fissaggio intermedie
 Assembly example with connecting brackets
 Exemple d'assemblage avec étriers de fixation intermédiaires

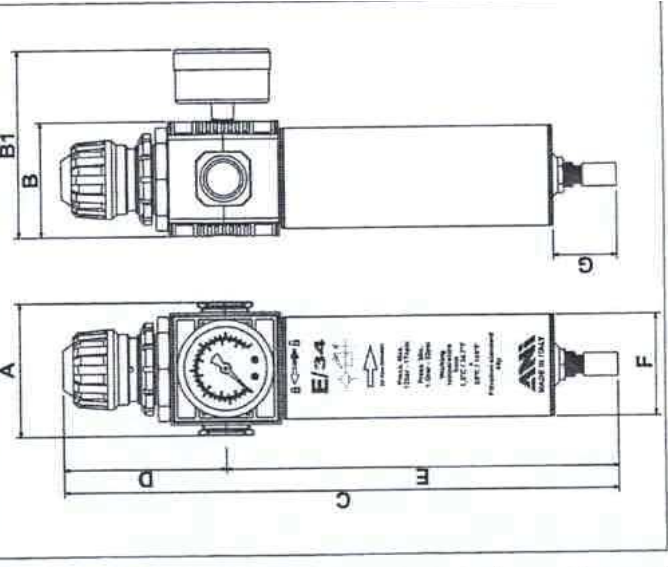
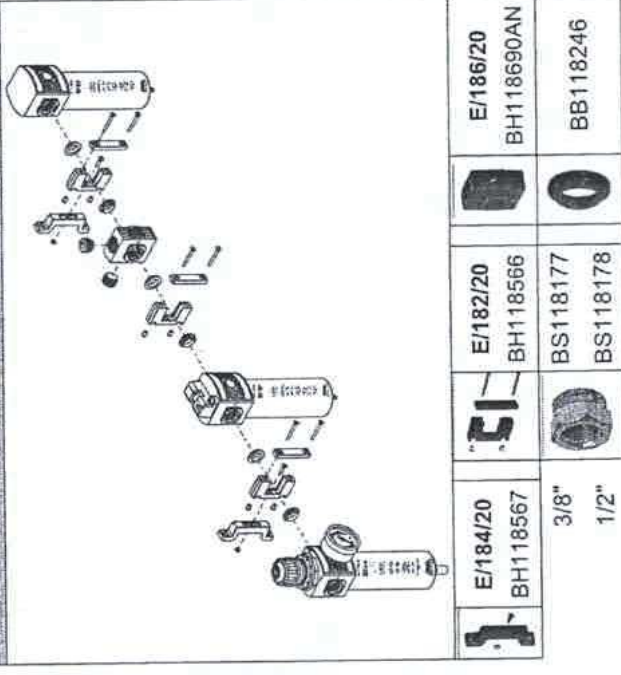

Pos.	Codice - Code
1	BH118685
2	BE118161
3	BS118217
4	BE118237
5	BE118236
6	BE118222
7	BB118219
8	BS118218
9	BS118220
10	BA118221
11	BH118039
12	BB118224
13	BH118686
14	BD118194
16	BM118506
17	BS118235
18	BH118229
19	BD078021
20	BA118233
21	BH118575
22	BS118239
23	BE118195
24	BS118041
25	BG118355
26	BE118043
27	BD118132
28	BH118513
29	BH118589 red BH1187772 black

